



LED HARSH ENVIRONMENT LINEAR LIGHT (HEL01)

(NON-HAZARDOUS)

Applications:

Suitable for industrial and commercial applications, replacing traditional fluorescent luminaires while providing energy savings and reducing maintenance costs. Ideal for non-hazardous and harsh industrial environments such as food processing, storage freezers, metals, power generation, aggregate and mining. Works great in traditional commercial settings as well.

FEATURES

Construction:

- Extruded Aluminum alloy body with superior heat transfer
- Robust design for harsh environments, IP 66 rated
- Slim and compact design for ease of installation in limited spaces
- IP66 rated for dust and wet locations

Optics:

- Polycarbonate lens designed for shock and anti-vibration
- Advanced optical system, provides superior uniformity and reduces glare
- Lumen package from 2,893 to 12,186 lumens
- Offering 120° beam angle

Electrical:

- Input power ranging from 20W to 90W
- Operating voltage is 100-277 VAC
- Power Factor >95%, THD <15%

Ambient Temperature:

- Operating temperature is -40°C to 40°C (-40°F to 104°F)

Mounting:

- Surface mount is standard; cable tray and pipe support are optional

Finish:

- Extruded aluminum alloy with frosted polycarbonate diffuser

Certifications:

- UL Listed – 1598
- Canada: CSA C22.2, No. 250
- Standard 5-Year Limited Warranty



20W
2-Foot



40W/50W/65W/90W
4-Foot

Actual performance may differ as a result of end-user environment and application. All values are design or calculated values measured in laboratory conditions. Specifications subject to change without notice.



SPECIFICATIONS

| Model | AO-HEL01-2Ft | | AO-HEL01-4Ft | | |
|------------------------------|---|----------------------------|---------------------------|---------------------------|---------------------------|
| Wattage | 20W | 40W | 50W | 65W | 90W |
| Input Voltage | 100~277VAC | | | | |
| Frequency | 50/60Hz | | | | |
| Power Factor (at full load) | >0.95, THD <15% | | | | |
| Conditions of Use | Altitude: 1500m / Ambient Temperature: -40°C ~ +40°C / Relative Humidity: Up to 100% | | | | |
| Driver Protection | Short Circuit, Overvoltage, Overcurrent, Overheating | | | | |
| Ingress Rating | IP66 | | | | |
| Impact Rating | IK08 | | | | |
| CRI | >80 | | | | |
| CCT | 5000K (±275K) | | | | |
| Beam Angle | 120° | | | | |
| Estimated Service Life | 100,000h (L70 B50) | | | | |
| Luminous Depreciation Factor | < 10% @ 50,000hrs | | | | |
| Luminous Flux | 2,893 lm | 5,503 lm | 6,627 lm | 8,560 lm | 12,186 lm |
| Efficacy | 145 lm/W | 138 lm/W | 133 lm/W | 132 lm/W | 134 lm/W |
| Body Material | Extruded Aluminum Alloy | | | | |
| Diffuser Material | Frosted Polycarbonate | | | | |
| Mounting | Surface, Cable Tray and Pipe Support | | | | |
| Weight | 1Kg | 2.2Kg | 2.2Kg | 2.2Kg | 2.2Kg |
| Dimensions (AxBxC) | 614 x 73 X 91 mm | 1175 x 73 X 91mm | 1175 x 73 X 91mm | 1175 x 73 X 91mm | 1175 x 73 X 91mm |
| Fluorescent Equivalent | 2x 16W / 2x 20W | 2x 32W / 2x 36W / 2x40W | 3x T5 HO 20W 2x T8 58W | 4x T5 HO 35W 3x T5 58W | 5x T5 HO 35W 4x T5 58W |

PHOTOMETRICS

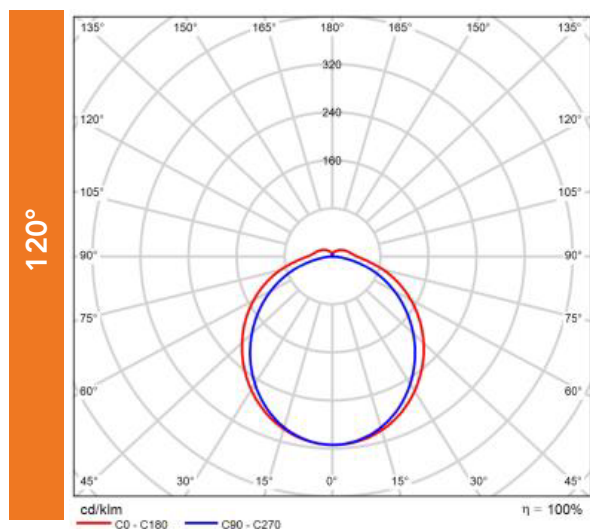

*Candelas for 1000 lumens

MOUNTING

Unit: inch/mm

WS-30° Wall Support

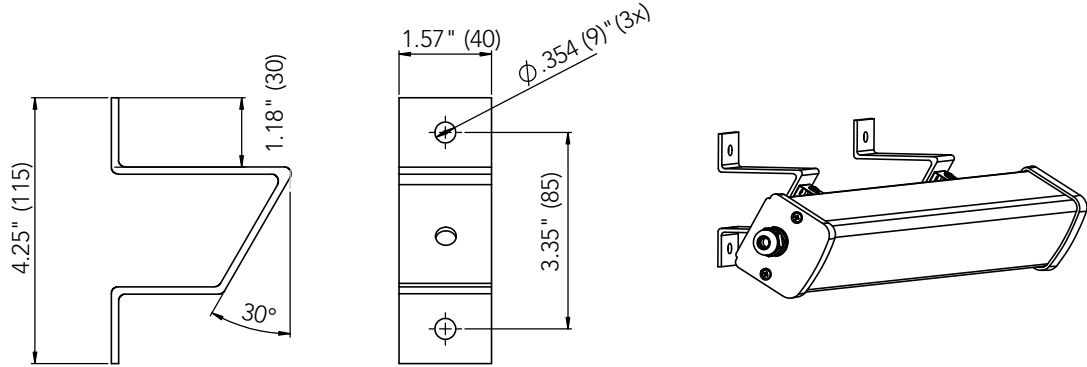

US-Unistrut Support

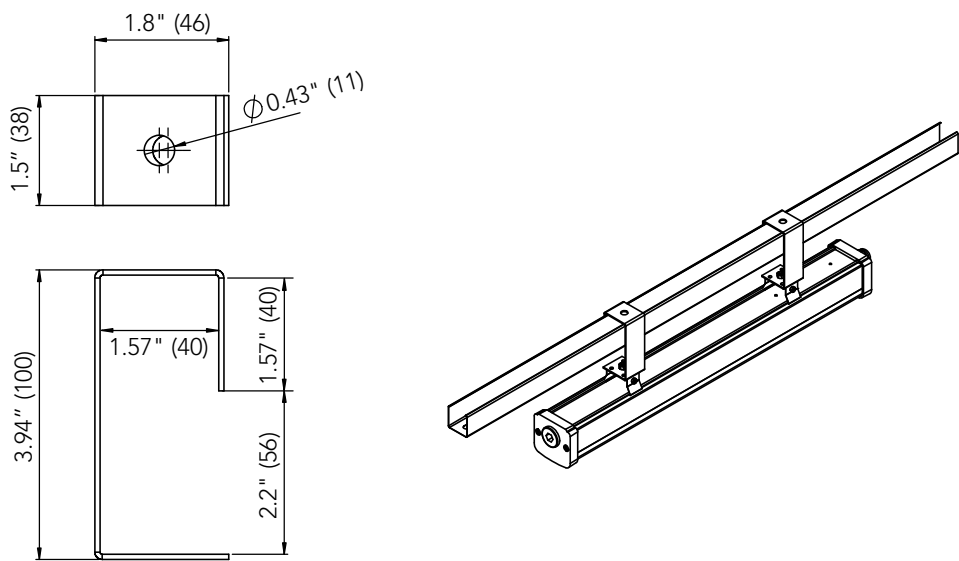

PS-Pipe Support

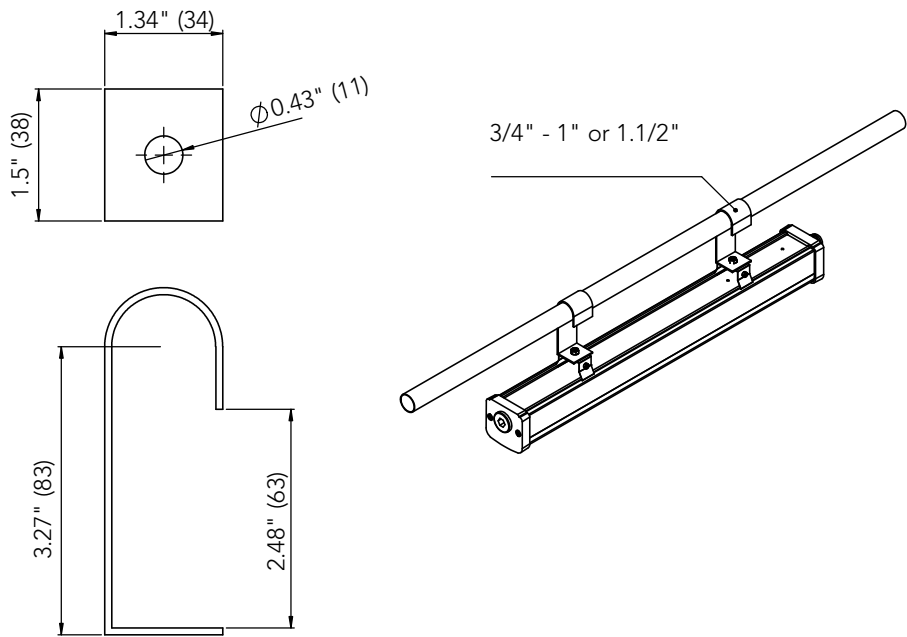

Default-Surface Mount

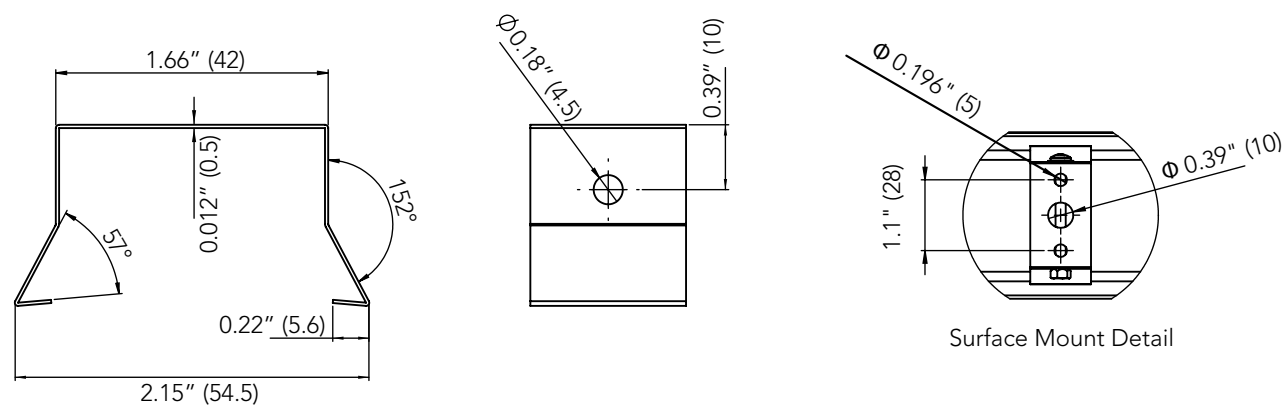

DIMENSIONS

Unit: inch/mm

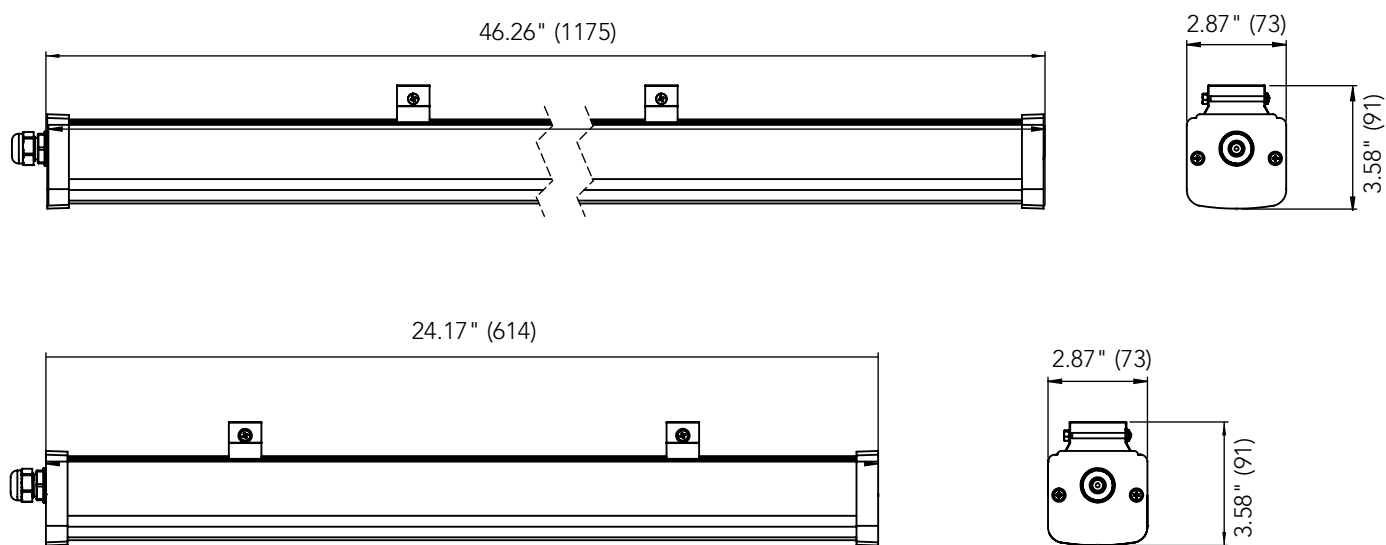

| ORDERING GUIDE | | | | | | Example: AO-HEL01-20-LV-50K-US | | | |
|--|--|---|--|--|--|--------------------------------------|--|---|--|
| Fixture Type | | Wattage | | Voltage | | CCT | | Options/Accessories | |
| AO- <input type="text"/> | | <input type="text"/> | | <input type="text"/> | | <input type="text"/> | | <input type="text"/> | |
| HEL01 Harsh Environment Linear Series | | 20 20W 40 40W 50 50W 65 65W 90 90W | | LV 110-277VAC 12 12VDC 24 24VDC | | 50K 5000K 65K 6500K | | Blank Surface Mount US 1-5/8" Unistrut Support CP¹ Custom Paint Color PS34 3/4" Pipe Support PS1 1" Pipe Support PS112 1-1/2" Pipe Support WS 30° Wall Support | |

Note: 1. Add color paint code to order number.



Alpha Omega Lighting
www.alphaomegalighting.com

347 N. Church Street • Ripley, WV 25271
Phone: 304-786-4055 • Email: info@alphaomegalighting.com

Specifications are subject to change without notice.
Updated 11-17-2023